

OUTLINE DRAWING:

RECOMMENDED PCB LAYOUT

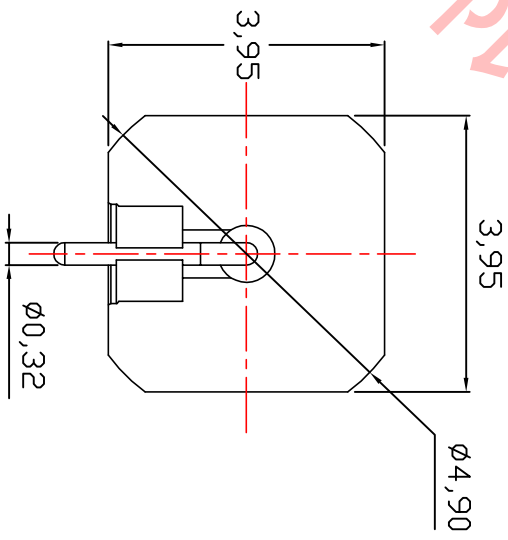
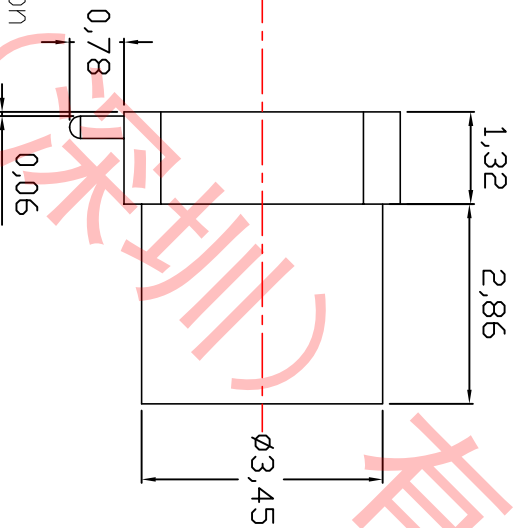
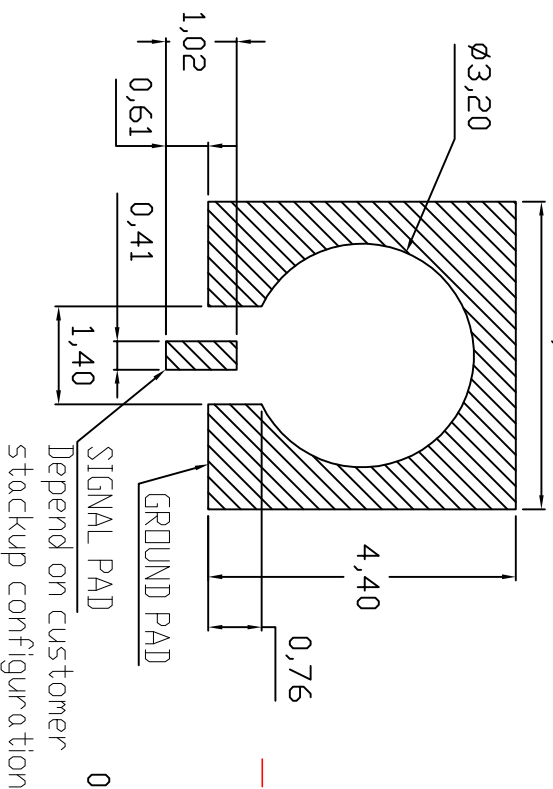

Above Pcb layout is for referance only, the trace impedance depends on pcb material, stackup, customised trace and so on. It is necessary to make a SI analysis before use this pcb layout

- NOTE:
1. IMPEDANCE: 50OHM
 2. FREQUENCY RANGE: DC~60GHZ
 3. RETURN LOSS: $\geq 15dB$ @60GHZ
 4. INSERTION LOSS: $0.05 \times \sqrt{\text{tr} \times \text{tf}}$ IN (GHZ)
 5. WORKING VOLTAGE: 500 VRMS
 6. INSULATION RESISTANCE: $\geq 5G\Omega$
 7. OPERATING TEMP: $-40 \sim +155^{\circ}C$

| | | |
|----------------|----------|--------------|
| BODY | BRASS | GOLD PLATING |
| DIELECTRIC | PEEK | NATURAL |
| CENTER CONTACT | BECCU | GOLD PLATING |
| DESCRIPTION | MATERIAL | FINISH |

| REV | DESCRIPTION | DRAWN BY | APPROVED BY | DATE |
|-----|--------------|----------|-------------|------------|
| A | FIRST ISSUES | FAN | Matthew | 26-07-2021 |

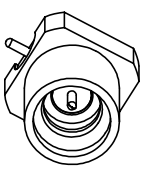

| | | | | | | |
|--|----|------------------|----------------|------------------------|-----|--------------------|
| DIMENSION: | MM | SERIES: | SMPM | CABLE: | N/A | <h2>DesignCon</h2> |
| General tolerance Unless Otherwise specified | | PRODUCT Spec: | ASSEMBLY INSTR | PART NUM: S10150059011 | | |
| 0 Plance: ±0.2 | | DRAWN: | FAN | DRAWING NUM: 015011 | | |
| 1 Plance: ±0.2 | | CHECKED: | FAN | SCALE: N/A | | |
| 2 Plance: ±0.2 | | APPROVED: | Matthew | REMARK | | |
| Angles: | | CUSTOMER DRAWING | | PAGE: 1/1 | | |
| This drawing is a controlled document | | | | | | |